

The **DEKORKONNECT™ WiFi Controller** allows wireless control of your **DEKOR®** installation from anywhere in the world. Fine-tune brightness, set schedules, and see the status of all your zones from the easy-to-use Bond Home app, even when you're nowhere near home. The controller is compatible with the **DEKOR® Plug-N-Play** system and can be used to control up to 60W of LED lights.

## HARDWARE SETUP

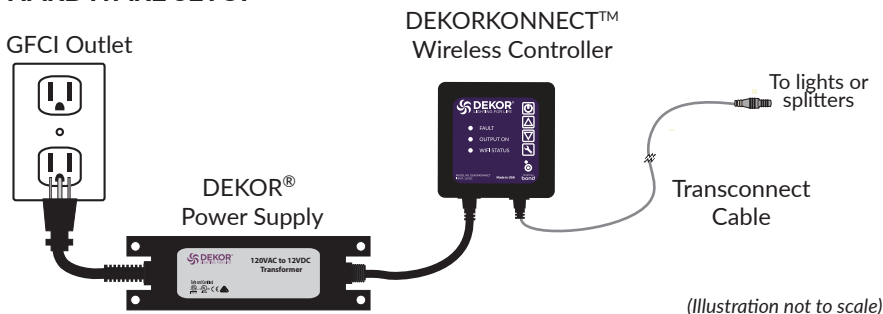

## CONTROLLER INSTALLATION

1. With the power supply unplugged, connect the input lead of the **DEKORKONNECT™** to the **DEKOR** power supply.
2. Connect the Transconnect cable to your light installation to the output terminal of the **DEKORKONNECT™**.
3. Plug the power supply into a GFCI-protected wall socket. If you see the red "FAULT" light, your system has reversed polarity. Check the polarity key on your input cable and correct any problems before proceeding. See "caution" on reverse.
4. Mount the WiFi controller in place with the included pressure sensitive adhesive strips and/or by replacing the installed black screws with the included 1.5" wood screws.

## CONTROLLER SETUP

1. On an Android or iOS device, download the Bond Home app.
2. Create an account and sign into the app.
3. The DEKORKONNECT™ wireless controller is a “Smart by Bond” device. Follow the in-app prompts to add the controller to your account and connect it to your home WiFi network.

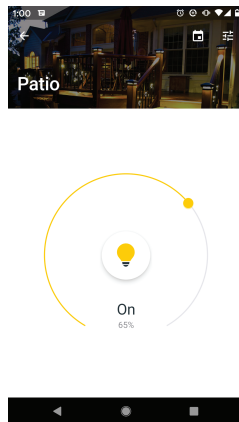
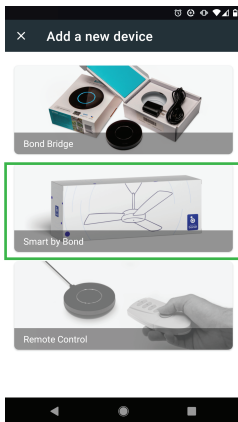
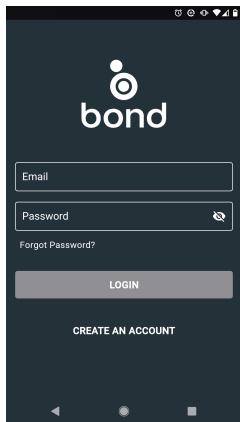

## CAUTION:

When making a connection between a Plug-N-Play connector or splitter, observe the polarity key to make a proper connection.

The male and female connectors have a flat side that **MUST MATCH UP**. Do not force the connectors together.

Plug-N-Play connectors are waterproof, but use of dielectric grease is mandatory for any connection with constant exposure to water. Dielectric grease should be added prior to connection.

