

EZ TRANSFORMER AND CONTROLLER ENCLOSURE

EZ TRANSFORMER AND CONTROLLER ENCLOSURE

This durable polycarbonate enclosure is designed to keep your electrical components (transformers and controllers) dry and to clean up your installation. The enclosure is built to withstand the elements and is completely watertight.

Product ID: **EZENCLOSURE**

Dimensions: Width: 10.75" X Length: 13.5" L X Depth: 6.4"



INSTALLATION INSTRUCTIONS

Mounting System – A mounting system that provides for various mounting options has been provided with the DEKOR® EZ Transformer and Controller Enclosure. To connect the mounting brackets, turn the enclosure so that the backside is visible. Place the mounting brackets over the octagon bosses either horizontally, diagonally, or vertically, and fasten them with ¼"-20 x .025" SS, countersunk Phillips drive screws (torque limit = 30 in. lbs.). The enclosure can be mounted vertically (ie. on a wall) or horizontally (ie. table top).

Lid/Door – The lid/doors have a gasket to seal against the base. Secure the lid/door to the base with screws, latches or screws and latches. Make sure the lid/door, gasket, and base are properly aligned. Four #10-32 x 0.75" SS, Phillips drive screws have been provided.

Screws: Screw down in four corners with screws provided (torque limit – 15 in. lbs.).

Screws & Latches: Screw down four corners or the two outside corners furthest from the hinge with screws provided (torque limit – 15 in. lbs.). Secure latches to base and close on lid/door.

Latches: Secure latches to base and close on lid/door.

CONSIDERATIONS

- If the enclosure is provided with specified modifications, installed accessories shall be of the same environmental rating.
- Bonding between conduit connections is not automatic and must be provided as a part of the installation. Do not use PVC cement for bonding.
- Conduit holes may be cut using standard hole screws. Secure the conduit, the connector and the locknut thru a pre-drilled hole. For metallic conduit, secure a grounding bushing over the connector locknut. All threaded inserts in the enclosure and for cover attachment are brass #10-32.
- Any fittings used, including conduit fittings and/or bonding between grounding bushings/lugs or between the grounding bushings/lugs and the devices installed inside the enclosure must be according to applicable governing Electrical Code.
- Enclosure drilled for conduit or other modifications voids the warranty and may not be returned.
- Conduit must be aligned into or out of enclosure to prevent enclosure damage due to bending stress in enclosure walls.
- A drainage hole may be created for 3R applications by drilling a 1/8 – ¼ inch hole on the enclosure side facing ground.
- For use in ordinary industrial applications and locations.

Before using the product, the user is advised and cautioned to make their own determination and assessment of the safety and suitability of the product for the specific use in question and is further advised against relying on the information contained herein or previously represented as it may relate to any specific use or application. It is the ultimate responsibility of the user to ensure that the product is suited and the information is applicable to the user's specific application. DEKOR® Lighting does not make, and expressly disclaim, all warranties or merchantability or fitness for a particular purpose, regardless of whether oral or written, express or implied, or allegedly arising from any usage of any trade or from any course of dealing in connection with the use of the information contained herein, previously represented or the product itself. The user expressly assumes all risk and liability, whether based in contract, tort or otherwise, in connection with the use of information contained herein, previously represented or the product itself. Further, information contained herein or previously represented is given without reference to any intellectual property issues, as well as federal, state or local laws which may be encountered in the use thereof. Such questions should be investigated by user.

For questions please contact us at 1-800-258-0344 or customerservice@dekorlighting.com

EZ TRANSFORMER AND CONTROLLER ENCLOSURE

OPTION 1

EZ TRANSFORMER AND CONTROLLER ENCLOSURE INSIDE PANEL KIT

Add a hinged panel to the inside of your enclosure to create a more efficient use of space and help keep all your components organized. Easy to install, with top or side opening options.

Product ID: **EZENCLOSUREKIT**

Dimensions: Width: 10.75" X Length: 13.5" L X Depth: 6.4"



Safe and Certified



INTERIOR PANEL INSTALLATION INSTRUCTIONS

Mounting Interior Panel –

Included with the Kit are four (4) hinged brackets, screws and an interior panel.

1. Determine whether you want to panel to swing open from the top or the side.
2. Slide one hinge into side or top slot to desired depth; use hinge set screw and snug hinge to enclosure.
3. Repeat. Set next hinge to same depth. Suggested: Use remaining two hinges as blocks on opposite side.
4. Attach panel to hinges using mounting screws.
5. Attach desired components to panel.

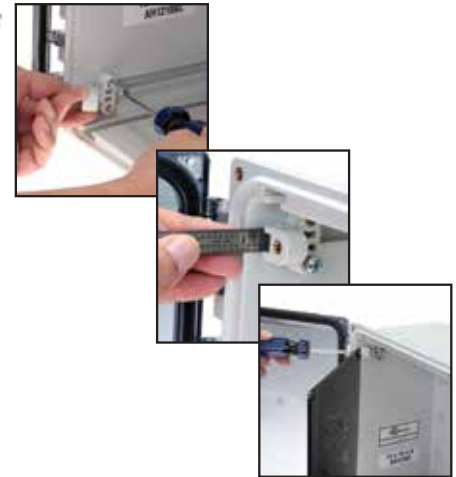

OPTION 2

EZ TRANSFORMER AND CONTROLLER ENCLOSURE KIT ASSEMBLED

Professional installation of panel and all your components. You select the components you want in the enclosure and we do the assembly. We will install your transformers and controllers (dimmers, photocell) into the enclosure, making your installation ultra-easy. Just screw the enclosure in place within 5' from the outlet you intend to use, plug into the Plug-N-Play connector and your off and running.

We drill either one or two holes (depending on all internal components ordered) for both the powder cord and the power outlet cable, in the bottom of the unit and install rubber grommets. This gives you a finished and professional look.

Assembly includes component installation and a complete functional checkout of all installed components.

Product ID: **EZENCLOSUREKITASSY**

Dimensions: Width: 10.75" X Length: 13.5" L X Depth: 6.4"



Safe and Certified



For questions please contact us at 1-800-258-0344 or customerservice@dekorlighting.com