

DEKOR® DOCKDOTS® Installation Instructions

General Information

- » ALWAYS check local codes before beginning your project. USE DEKOR® TRANSFORMERS for the Limited Lifetime warranty. Using any other type of transformer the lights will have a 3-year warranty.

TRANSFORMER CAPACITY BY TYPE		
Example	5A Transformer EZ Max Transformer	2.5A Transformer EZ Transformer
DOCKDOTS®	45	25
DOCKDOTS® Nexgen	22	13

The list above is for maximum number of each individual types of lights.
If mixing and matching lighting reference the transformer calculator at www.dekorlighting.com.

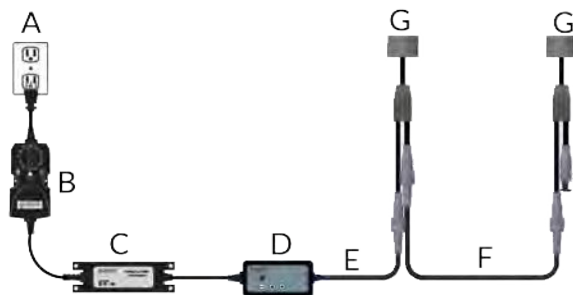

- Connect the DEKOR® timer to an outdoor rated GFCI outlet.
- Install the timer vertically with the outlets facing down. Timer must be installed a minimum of 1'(305m) above ground level.
- Plug the DEKOR® Transformer into one of the timer outlets.
- Connect the male input pigtail from the dimmer to the output of the transformer.
- Connect the 2-wire transformer connection Plug-N-Play cable to the first DOCKDOT® in the run.
- 2-Wire 20', 5', 10', 20' male to male Plug-N-Play cable
- DOCKDOT® female connectors are both input/outputs.

Note: It is recommended to install the transformer and controllers in an EZENCLOSURE.

- Mark location for DOCKDOTS® lights on deck boards.

NOTE: Avoid locations over joists when possible because it will be more difficult to drill holes. Use the DOCKDOT® forstner bit 1" (25.4 mm) and drill a hole 11/16" (17.46mm) deep into board. Drill a 3/4" (19.05mm) hole in the base of the light hole through deck board, for the DOCKDOT® pigtail.

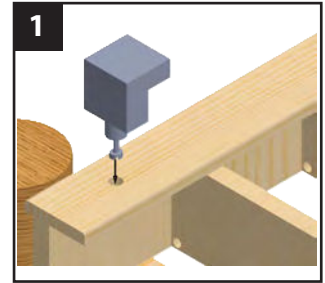

- If the 1" DOCKDOT hole passes through the entire deck board apply a bead of silicone around the side of the DOCKDOT before proceeding to step 2.

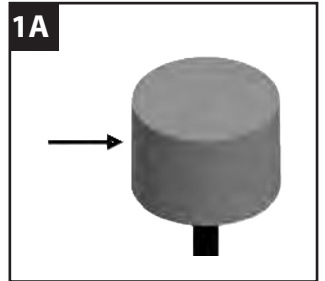

- Feed the DOCKDOT® pigtail through the hole in the deck board. Carefully press or tap the DOCKDOT into the hole until flush. DO not pull down on the pigtail to seat the DOCKDOT® in the hole.

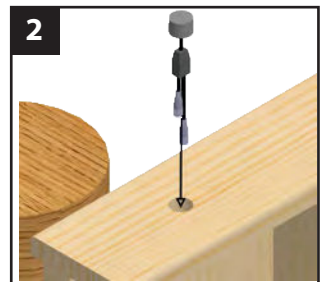

- Make the connections to each light with the plug-n-play cables. Thread collars on to female connectors finger tight to seal connections. Add dielectric grease and cap off unused female connector ends. Do not run cables between joist and deck boards. **Do not run cables in locations that are constantly submerged in water.**

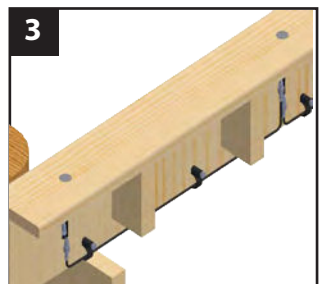

- Secure plug-n-play cables with wire clips. Do not use wire staples as they can pierce the insulation and cause a short.

